



WAMPLER[®]
BUILT IN USA

Syntax Multifunction Switcher
Quick Reference Guide



The Wampler Syntax is a micro format multifunction remote switcher - perfect for use with the Catacombs, Metaverse, and Terraform.

The Syntax has two primary capabilities:

1. As a standalone MIDI Controller capable of outputting PC messages 1 through 8 to synchronize presets on MIDI-enabled devices via the MIDI OUT jack
2. As a customizable external TRS switch capable of outputting tap and/or latching switch outputs via the TRS EXT OUT jack

These functions are performed with the left and right footswitches. The left and right slide switches select the function (MIDI, TAP, LATCHING) for the respective footswitch. The Syntax may operate in any combination of modes based on the position of the slide switches.

Power: This pedal was designed around the usage of a 9-18V DC power source. To avoid damage to the pedal, do not exceed 18V DC, do not use center pin positive adapters, and do not use AC power. Use only a 9-18V DC power source that is intended for guitar pedals.

This pedal draws approximately 20mA.

Setup: The Syntax requires minimal setup in order to interface with MIDI-enabled devices. The only step required is to set the Syntax's MIDI Channel to match the device it will be controlling. Please see Page 4 for Setup instructions and diagrams.

Connect a 1/8" TRS cable to the EXT OUT to use TAP and LATCH functions. The tip and ring may be configured to either tap or latching style outputs, and are triggered by the footswitches. If only one slide switch is set to TAP or LATCHING (i.e. the other slide switch is set to MIDI), the respective footswitch will output via the tip of the EXT jack, and the ring will be disabled (See Figures 3 & 4). If both slide switches are set to either TAP or LATCHING (i.e. neither slide switch set to MIDI), the left footswitch will output via the ring of the EXT jack, and the right footswitch will output via the tip of the EXT jack.

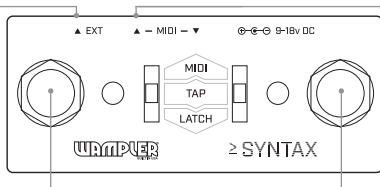

The Footswitches have three separate modes. The left and right slide switches select the function (MIDI, TAP, LATCH) for the respective footswitch. The Left switch decrements the MIDI PC message, the Right switch increments it.

- MIDI** - change the program via MIDI PC message via MIDI OUT jack
- TAP** - outputs a tap pulse via EXT OUT
- LATCH** - toggles the output of EXT OUT

Connect a 1/8" TRS cable to the MIDI OUT (▲).

In MIDI Mode, the Syntax maintains an internal program number between 1 and 8; this program number is updated up or down by pressing the footswitches, and the updated program number is output as a MIDI PC (PC1 through PC8) message via the MIDI Out jack (See Figure 2).

MIDI IN (▼) is used for setup and when part of a larger MIDI environment - all MIDI messages received via the MIDI IN jack will be passed through to the MIDI OUT jack (See Figure 1).

Hardware routing and setup procedure (assign MIDI channel)

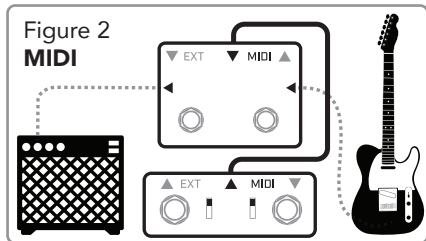
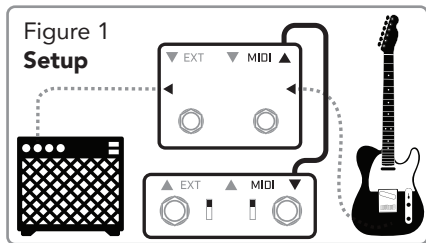

Using Catacombs, Metaverse, or Terraform*

1. Connect a 3.5mm TRS cable between the MIDI OUT of the Metaverse/Catacombs and the MIDI IN of the Syntax Switcher (*See Figure 1*).
2. While powered off, hold both footswitches on the Syntax, power up the Syntax, and release both switches after both LEDs begin blinking.
3. On the Metaverse/Catacombs, press the preset switch; this will output a MIDI PC message to the Syntax containing the MIDI Channel.
4. The Syntax will receive and store the new MIDI Channel, and the LEDs will blink quickly to indicate the MIDI Channel has been successfully received.
5. The Syntax will now output MIDI PC messages with the newly associated MIDI Channel.
6. Following Setup, reroute cables to match Figure 2 for MIDI operation.

**Note: only later revisions of the Terraform support this method. Please visit wamplerpedals.com/products/modulation/terraform/ and click on 'More Info'.*

As the original Terraform does not output a MIDI PC message when the preset switch is pressed, the setup process differs.

Configure the Terraform's MIDI Channel to Omni Mode by holding down the preset switch, powering up the Terraform, selecting Omni Mode, and saving. Consult the Terraform manual for more detailed information.

Setup with 3rd Party MIDI devices:

Use the same method but follow your hardware's instructions for sending MIDI PC commands.

Figures 3-4 show suggested alternate configurations for your reference.

For additional documentation please visit wamplerpedals.com.

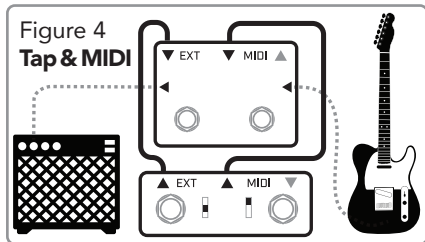
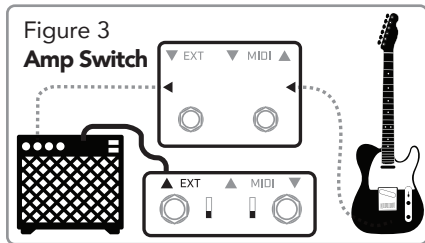

WAMPLER Pedals Limited Warranty.

WAMPLER offers a 5 year warranty to the original purchaser that this WAMPLER product will be free from defects in material and workmanship. A dated sales receipt will establish coverage under this warranty. This warranty does not cover service or parts to repair damage caused by accident, neglect, normal cosmetic wear, disaster, misuse, abuse, negligence, inadequate packing or shipping procedures and service, repair or modifications to the product, which have not been authorized by WAMPLER. If this product is defective in materials or workmanship as warranted above, your sole remedy shall be repair replacement as provided below.

RETURN PROCEDURES In the unlikely event that a defect should occur, follow the procedure outlined below. Defective products must be shipped, together with a dated sales receipt, freight pre-paid and insured directly to WAMPLER SERVICE DEPT – 5300 Harbor Street, Commerce, CA 90040, USA. A Return Authorization Number must be obtained from our

Customer Service Department prior to shipping the product. Products must be shipped in their original packaging or its equivalent; in any case, the risk of loss or damage in transit is to be borne by the purchaser. The Returns Authorization Number must appear in large print directly below the shipping address. Always include a brief description of the defect, along with your correct return address and telephone number. When emailing to enquire about a returned product, always refer to the Return Authorization Number. If WAMPLER determines that the unit was defective in materials or workmanship at any time during the warranty period, WAMPLER has the option of repairing or replacing the product at no additional charge, except as set forth below. All replaced parts become a property of WAMPLER. Products replaced or repaired under this warranty will be returned via ground shipping within the United States freight prepaid. WAMPLER is not responsible for costs associated with expedited shipping, either to WAMPLER or the return of the product to the customer.

INCIDENTAL OR CONSEQUENTIAL DAMAGE In no event is WAMPLER liable for any incidental or consequential damages arising out of the use or inability of the possibility of such damages, or any other claim by any other party. Some states do not allow the seclusion or limitation of consequential damages, so the above limitation and exclusion may not apply to you.

This warranty gives you specific legal rights and you may also have other rights which may vary from state to state.

This equipment has been tested and found to comply with the limits for a Class B digital device, pursuant to part 15 of the FCC Rules. These limits are designed to provide reasonable protection against harmful interference in a residential installation. This equipment generates, uses and can radiate radio frequency energy and, if not installed and used in accordance with the instructions, may cause harmful interference to radio communications. However, there is no guarantees that interference will not occur in a particular installation.

If this equipment does cause harmful interference to radio or television reception, which can be determined by turning the equipment off and on, the user is encouraged to try to correct the interference by one or more of the following measures:

- Reorient or relocate the receiving antenna.
- Increase the separation between the equipment and the receiver.
- Connect the equipment into an outlet on a circuit different from that to which the receiver is connected.
- Consult the dealer or an experience radio/TV technician for help.

Changes or modifications not expressly approved by the party responsible for compliance could void the user's warranty to operate the equipment.

FOR YOUR PROTECTION Please complete the online warranty registration within (10) ten days of the date of purchase so that we may contact you directly in the event of a safety notification issued in accordance with the 1972 Consumer Product Safety Act.

Visit wamplerpedals.com for additional manuals and product videos. Sign up for our newsletter to get the latest information and offers on product releases and be sure to check out the Chasing Tone podcast for the inside scoop at Wampler.

Customer Support

Our dedicated staff are ready to help you with any warranty or product questions – please email us at help@wamplerpedals.com or call us on (765) 352-8626. Please remember to register your pedal as soon as possible after purchase at the following web page to ensure quicker service if you should ever need to make a warranty claim: wamplerpedals.com/warranty-registration



https://www.youtube.com/@wampler_pedals



@WamplerPedals



/WamplerPedals



@WamplerPedals

**SCAN
ME!**



WAMPLER[®]
BUILT IN USA